



## Antenna Mounting Instructions

### FILM-NB-GPS

#### INSTALLATION USING FILM ANTENNA MOUNTED ON GLASS:

1. Use alcohol swipe to clean dirt and dust particles from glass surface.
2. Install with glass above 65° F. so film does not appear cloudy.
3. Mount on glass between 1/8" - 1/4" (4-6mm) thick.
4. Refer to Figure 1 - Antenna Placement
5. When choosing placement, leave room to attach amplifier.

**Note:** Film antenna must be kept at least 2" away from metal. Orientation of antenna is not critical.

6. Remove adhesive backing from film using pull-tabs. Avoid getting fingerprints on adhesive.

OPTIMUM POSITIONS ARE 1, 2 & 3.

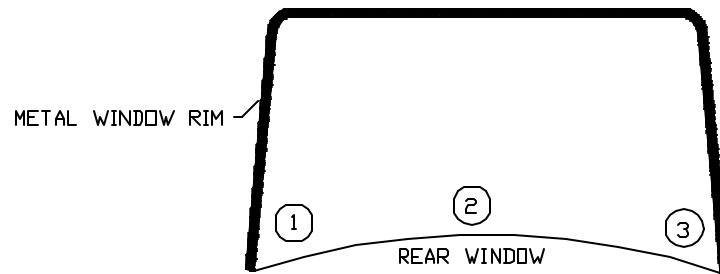
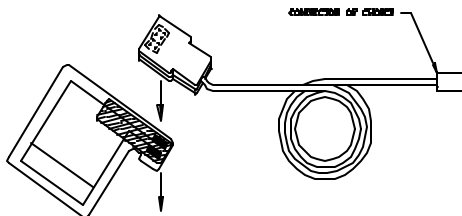

Figure 1 – Antenna Placement

7. After adhering film to glass, press out any air bubbles.
8. Remove top film protecting the antenna contact points.
9. Peel backing tape from amplifier using pull-tabs.
10. Line up amplifier terminal points with the points on the film. (Figure 2)
11. Apply pressure for 20-30 seconds. Adhesive cures in 5-10 minutes.

Figure 2 – GPS Film Antenna



#### INSTALLATION USING DURABLE RE-USABLE PLASTIC CARD:

1. Remove protective film from plastic card before attaching antenna.



2. Use figure 3 as a transparent template for correct antenna placement on plastic card.
3. Remove adhesive backing from film using pull-tabs. *Avoid getting fingerprints on adhesive.*

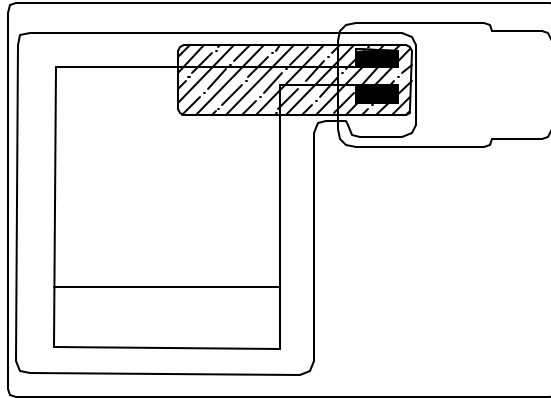

**Figure 3 - GPS Film Antenna Template**

4. After adhering film to card, press out any air bubbles.
5. Remove top film protecting the antenna contact points.
6. Peel backing tape from amplifier using pull-tabs.
7. Line up amplifier terminal points with points on the film (Figure 4).
8. Apply pressure for 20-30 seconds. *Adhesive cures in 5-10 minutes.*
9. Use with or without adhesives. (not supplied) for temporary mounting.

*Antenna is not weather resistant.*

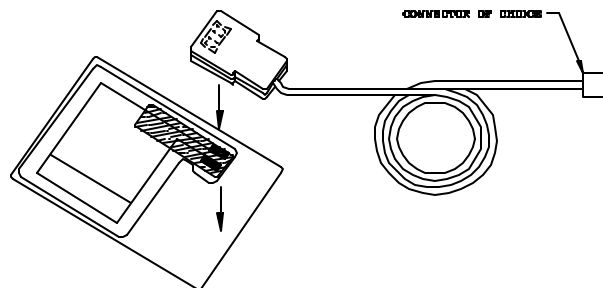

**Figure 4 Plastic Card Installation**